

**PRODUCT CODE: LR2**  
MILLED EDGE LOCKRING



**DESCRIPTION**

25mm Milled Edge Lockring

**FINISH**

BZP

**MATERIAL**

Steel

**PACKAGING**

Packed in qty 100

**ADDITIONAL NOTES**

Conforms to BS EN61386-1  
Compliant to LU Standard 1-085 (for use on surface & sub-surface locations)

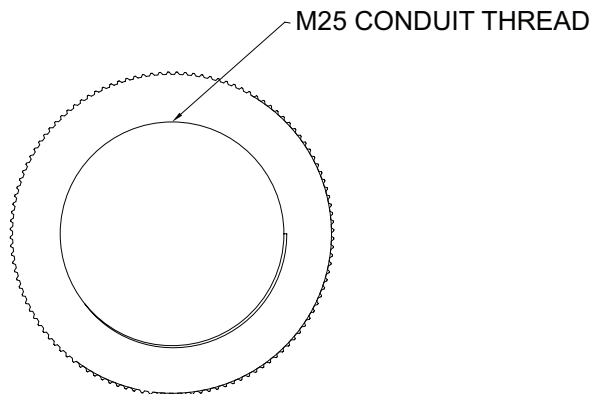
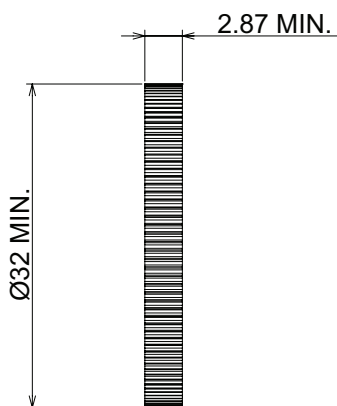
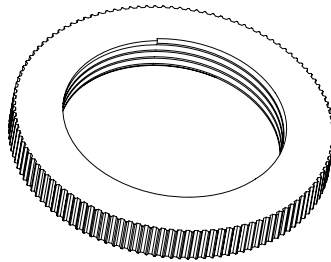

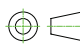
 Values are nominal and with a general tolerance  $\pm 5\%$  unless otherwise specified